

Howell's montia Research Project 2008
 Chadd Creek A39
 Occurrences 14, 553, 554, 844, 845, 846, and 847
 T1S, R2E, Section 5

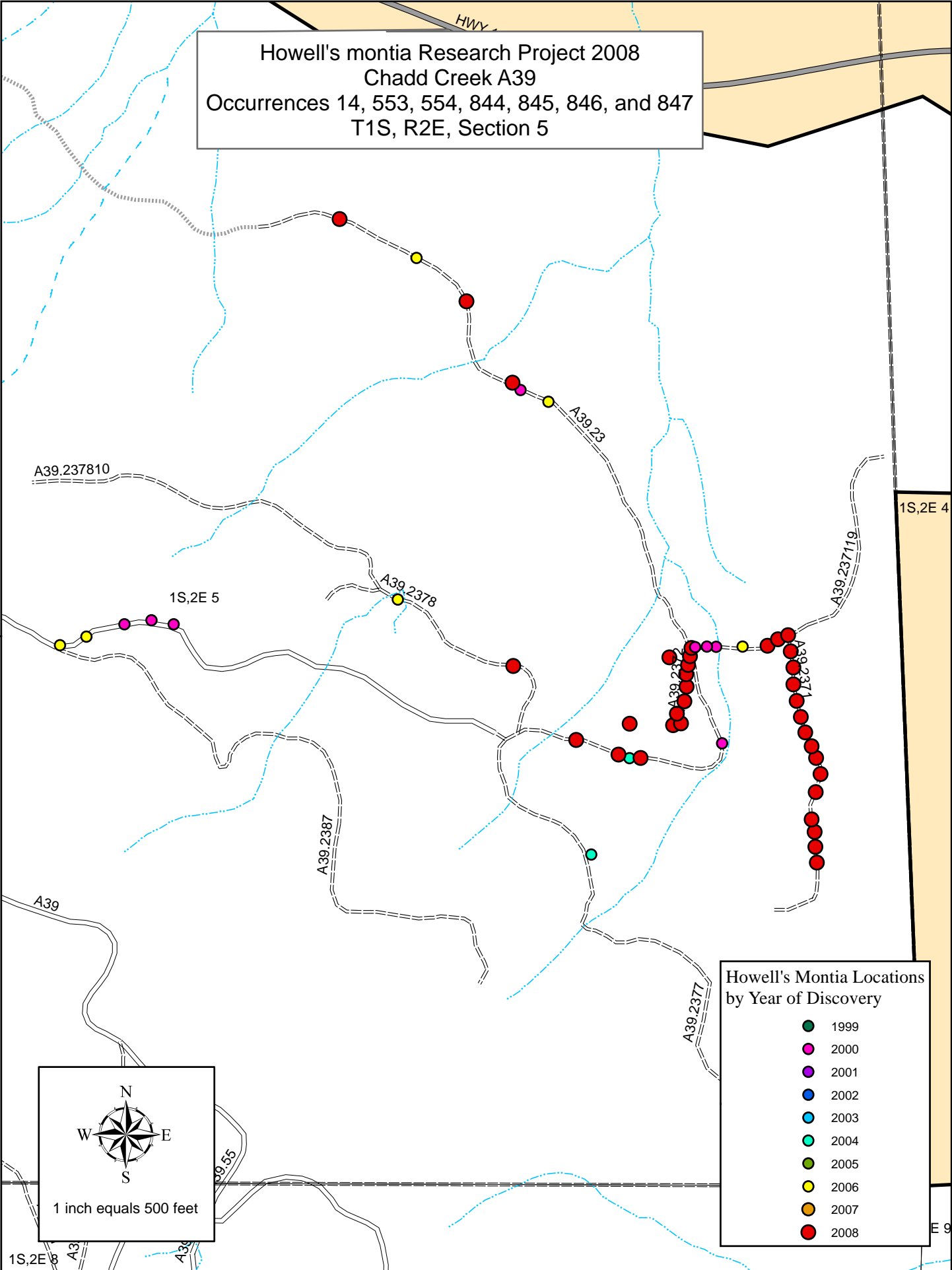

- Howell's Montia Locations
 by Year of Discovery
- 1999
 - 2000
 - 2001
 - 2002
 - 2003
 - 2004
 - 2005
 - 2006
 - 2007
 - 2008

1 inch equals 500 feet