

Howell's montia Research Project 2008
 Larabee E40
 Occurrences 367, 368, 532, 565, 566, 567,
 570, 848, 849, 850, and 888
 T1S, R3E, Sections 16 and 17

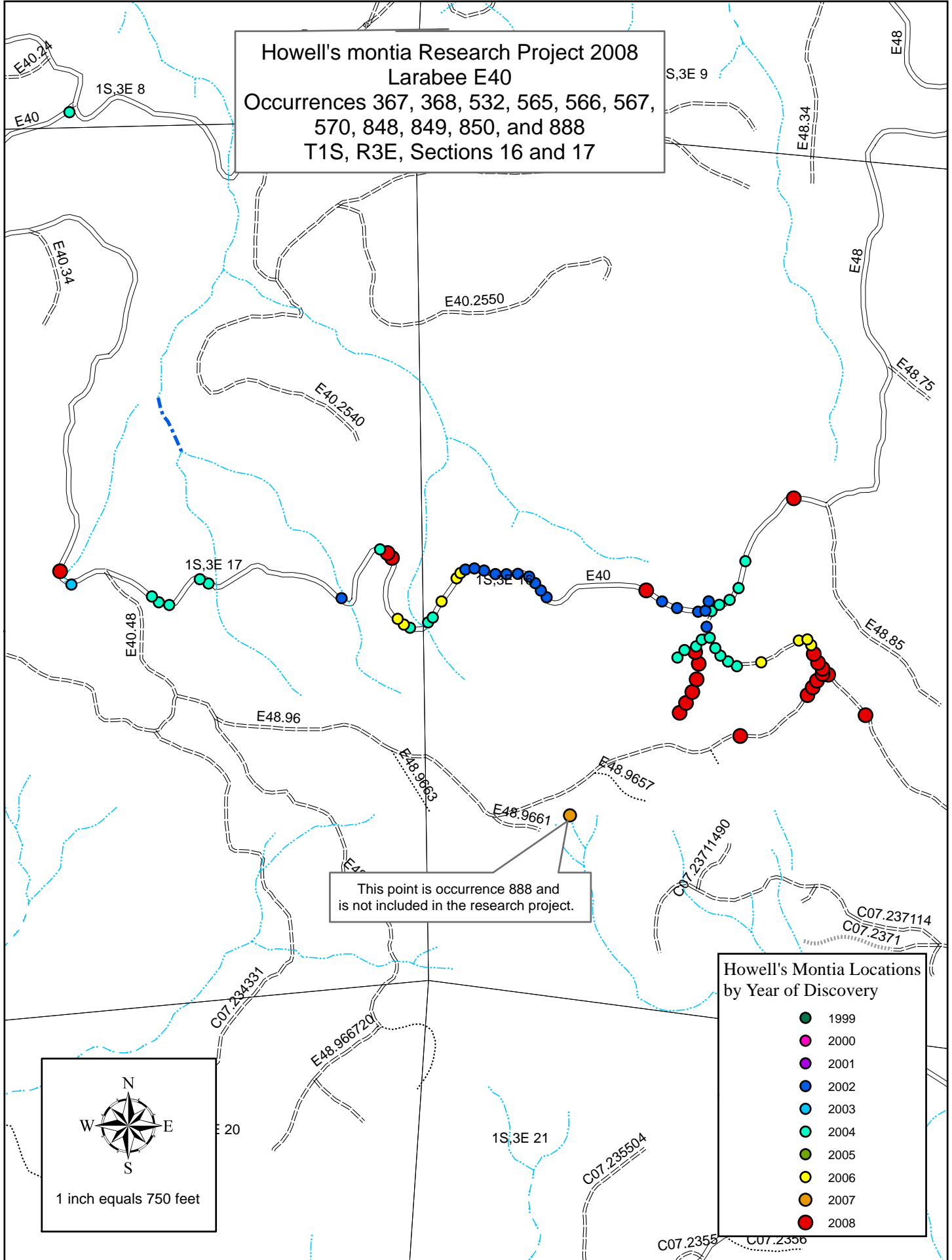

This point is occurrence 888 and is not included in the research project.

- Howell's Montia Locations by Year of Discovery**
- 1999
 - 2000
 - 2001
 - 2002
 - 2003
 - 2004
 - 2005
 - 2006
 - 2007
 - 2008

